

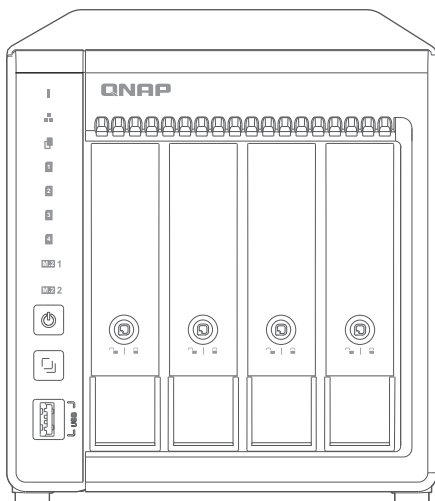

NAS 网络存储器

Quick Installation Guide

快速安装指南



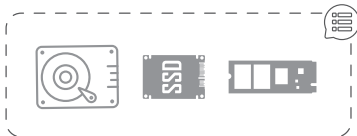
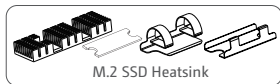
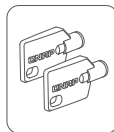
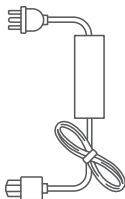
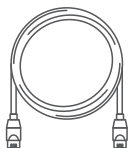
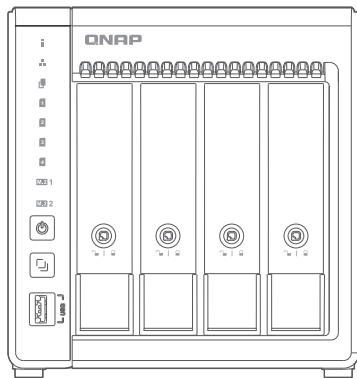

The accessories marked in the dotted box vary with the device model, configuration, and package type. Please refer to the purchase package or consult the customer service of the retailer.

en

虚线框内所标明的配件·因设备型号·配置·套餐类型会略有差异·具体请以您购买时内容物为准或咨询购买渠道。

cn



HDD/SSD
<http://www.qnap.com/compatibility>

All the drive data will be cleared upon HDD initialization

en

所有硬盘(SSD / HDD)上的数据都将会被清除

cn

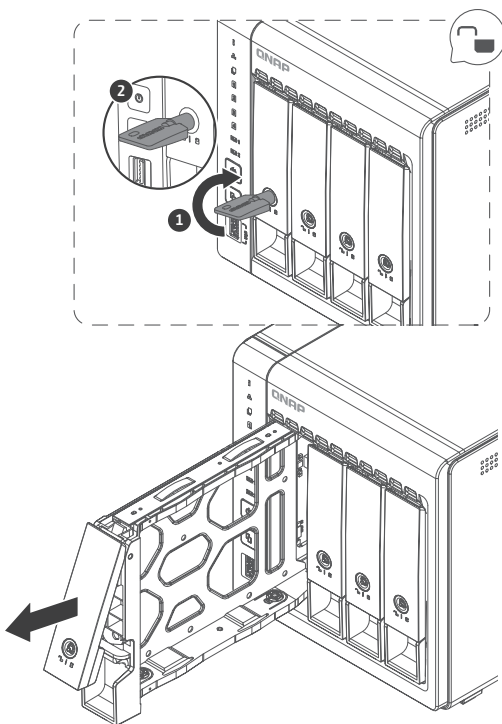

01

2.5" HDD / SSD

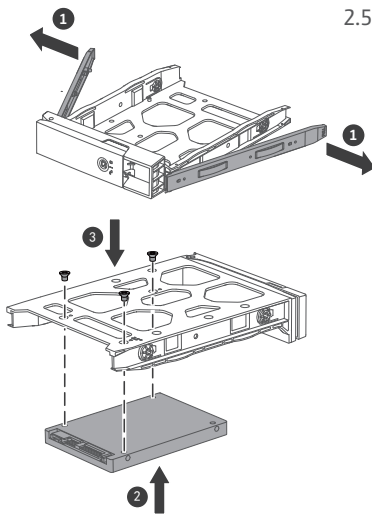

3.5" HDD

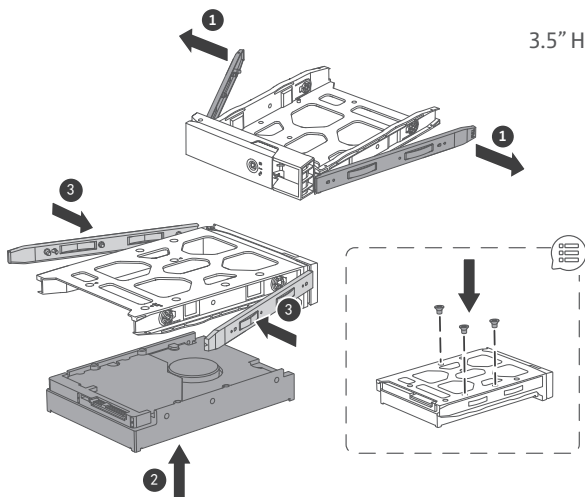

2.5" HDD / SSD

3.5" HDD

03

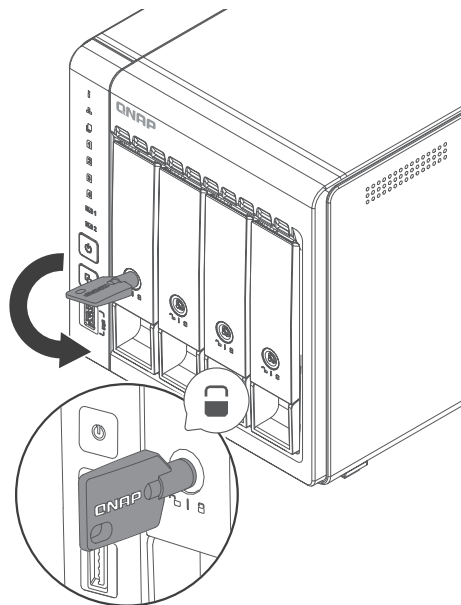
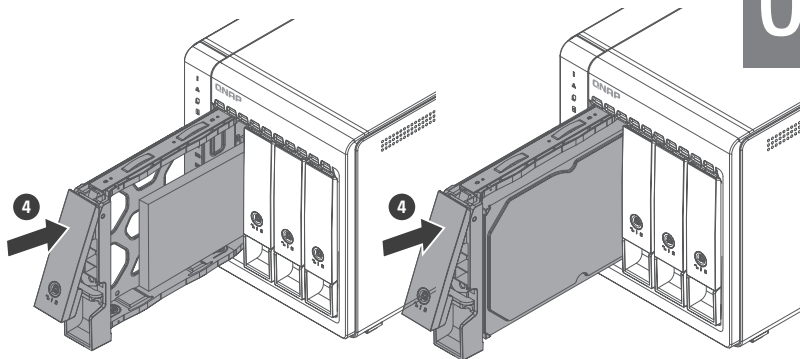

04

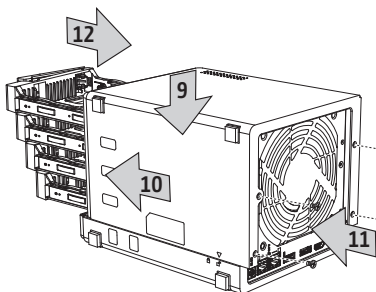
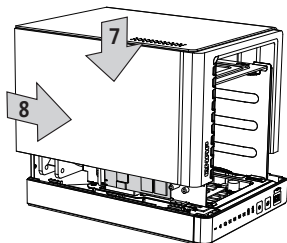
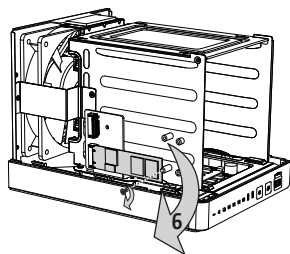
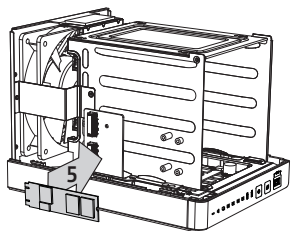
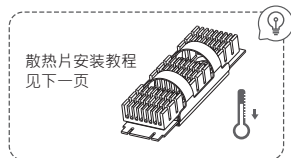
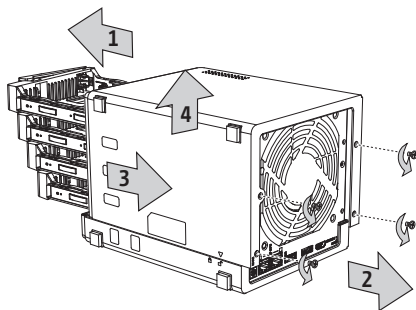

1 撕下散热片底部的保护膜

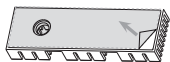

2 将散热片置于M.2 SSD上

a. 将M.2 SSD插上NAS的M.2插槽，来判断哪一面应该朝上

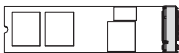

b. 将散热片放置到M.2 SSD的上方，让控制器（下方圆圈标示处）与散热片的底部完全接触

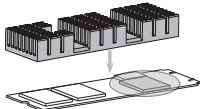

下方图片显示M.2 SSD上散热片安装位置

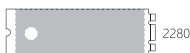

3 将散热片与M.2 SSD放于保护壳上

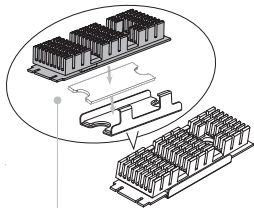

选择性 如果固定扣夹无法妥善固定保护壳，可在M.2 SSD与保护壳上方之间安装垫片来加强固定

4 安装固定扣夹

a. 轻轻压住散热片与保护壳，将固定扣夹以35度角卡入。

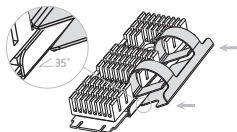

b. 装入固定扣夹。

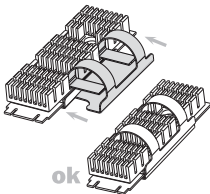

拆解组件

1 将固定扣夹往外推。

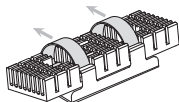

2 将散热片与保护片分离

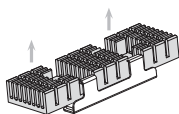

06

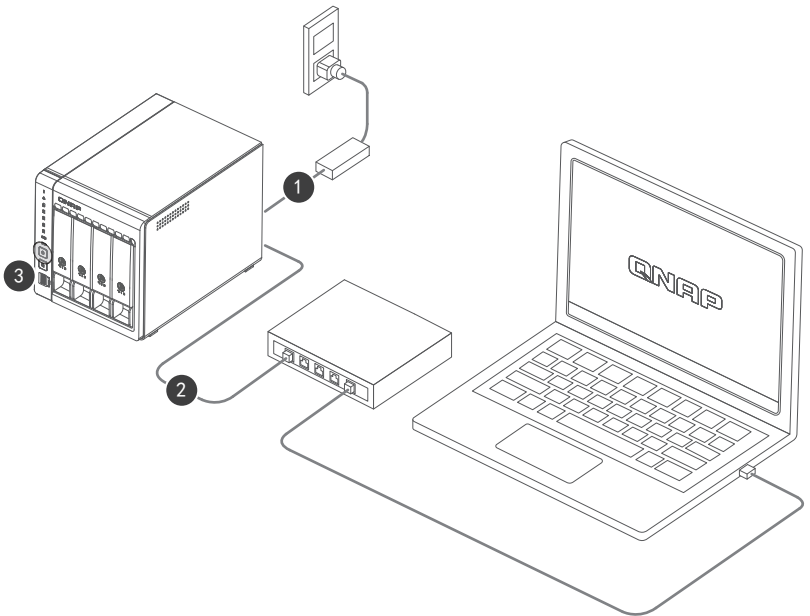
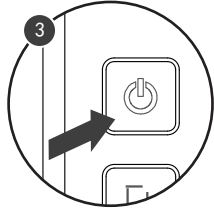
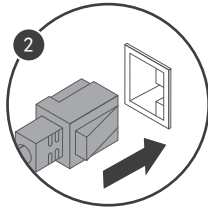
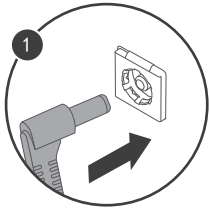

 Qfinder Pro

 Windows

 Mac

 Linux

<http://www.qnap.com/qfinderpro>

a



b

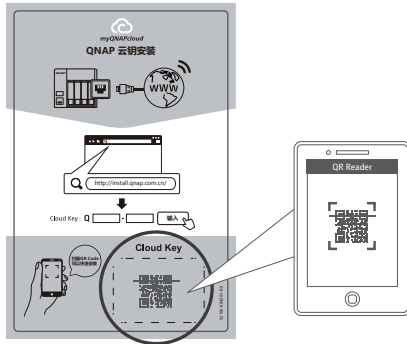

Reset

admin

MAC Address #1

Login



Download Center
www.qnap.com/download

Visit Download Center for our full guides and utilities. -----

en

有关完整指南和实用工具，请访问“下载中心”。-----

cn

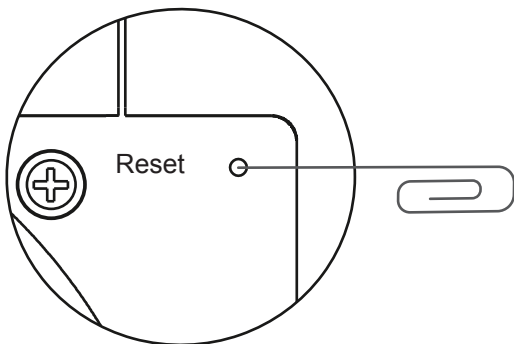

To revert to the default password, use a pin to press the Reset button for three seconds or until you hear a short beep-----

en

欲恢复到默认密码，请用针状物抵按Reset键3秒或直至听见短促“哔”声-----

cn



According to the requirement of the WEEE legislation the following user information is provided to customers for all branded QNAP products subject to the WEEE directive.

This symbol on the product or on its packaging indicates that this product must not be disposed of with your other household waste. Instead, it is your responsibility to dispose of your waste equipment by handing it over to a designated collection point for the recycling of waste electrical and electronic equipment. The separate collection and recycling of your waste equipment at the time of disposal will help to conserve natural resources and ensure that it is recycled in a manner that protects human health and the environment. For more information about where you can drop off your waste equipment for recycling, please contact your local city office, your household waste disposal service or the shop where you purchased the product.

根据 WEEE 法规的要求，以下用户所应了解的信息针对所有符合 WEEE 规范的 QNAP 品牌产品提供给用户。

带有此符号的产品或包装表示该产品不得与您的其他生活垃圾一起处理。相反，您有责任将其交给指定的电子电气设备回收站来处理您的废弃设备。在处置时分开收集和回收您的废弃设备，并确保以保护人类健康和环境的方式对其进行回收，将有助于保护自然资源。有关您将废弃设备丢弃在哪里以进行回收的更多信息，请联系您的所在地办事处、您的家庭垃圾处理服务机构或您购买产品的商店。



Warning: Batteries may explode if not handled properly. Follow local regulations when disposing of used batteries.

注意：用错误型号电池更换会有爆炸危险，务必按照说明处置用完的电池。



HDMI, HDMI High-Definition Multimedia Interface (高清晰度多媒体接口) 等词语，HDMI 商业外观和 HDMI 标识均为 HDMI Licensing Administrator, Inc. 的商标或注册商标。

本文提及的其他公司名称和产品是其各自持有者的商标或注册商标。

The terms HDMI, HDMI High-Definition Multimedia Interface, HDMI Trade dress and the HDMI Logos are trademarks or registered trademarks of HDMI Licensing Administrator, Inc.



install.qnap.com



service.qnap.com



download.qnap.com

QNAP[®]

P/N: 51000-0XXXXX-HF
Printed in China